



# **OPERATOR'S MANUAL**

## **Freestall Groomer**

**Model FSG Serial Number 11157-**

**Model FSG3PT Serial Number 13938-**

**Manual# 96336 AUG 2020 ENGLISH**

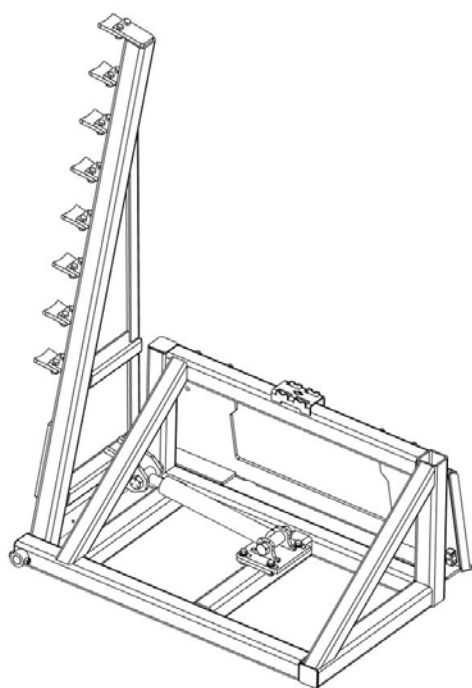

COPYRIGHT © 2020

MESSER REPAIR AND FABRICATING LLC

SAUK CENTRE, MN

PRINTED IN USA

ALL RIGHTS RESERVED

# Introduction

## Using This Manual

The term loader is used in this manual to refer to a skid steer loader.

Your loader operator's manual contains instructions to safely operate the loader. Anyone who operates a loader with this attachment installed must first read, understand and follow the instructions in the loader operator's manual.

This manual contains instructions to safely operate and service the attachment. Anyone who operates or services the attachment must first read, understand and follow the instructions in this manual.

Additional operating or servicing information for the attachment may be provided online, in video, or in other publications. This additional information does not replace, and is not a substitute for reading and following, the instructions in this manual.

The safety alert symbol is shown in WARNING statements to alert users to hazards which could cause death or injury. Carefully read and follow the messages.

IMPORTANT notices alert users to instructions which, if not followed, could result in damage. Carefully read and follow the messages.

There may be times when the attachment and loader shown in this manual may not be your exact model. The model shown will be close enough to your attachment or loader to accurately convey the information.

The most current information available is included in this manual. The publisher may revise this manual at any time and is not required to notify users of revisions.

## Replacement Manuals

Be sure to include this operator's manual if you sell or transfer ownership of the attachment.

Contact Messer Repair and Fabricating, LLC for a printed manual, or find a downloadable manual on our website.

## Using This Attachment

The attachment is designed to groom and slope bedding in stalls.

The attachment model FSG is designed for installation on a full-size loader, connected to the loader's front auxiliary hydraulic couplers. The attachment model

FSG3PT is designed for installation on a Category 1 or 2 tractor Rear 3 Point Hitch.

The manufacturer reserves the right to make improvements, and to discontinue or change specifications, models or design without notice and without incurring obligation.

## Loader Compatibility (FSG)

Confirm your loader's Rated Operating Capacity in the loader operator's manual. Do not install the attachment on the loader if it will exceed the Rated Operating Capacity during operation because this may cause difficulty in controlling the loader or may cause loader damage.

## Tractor Compatibility (FSG3PT)

Confirm your tractor and 3 Point Hitch operating capacities in the operator's manuals. Do not install the attachment on the tractor if it will exceed capacity during operation because this may cause difficulty in controlling the tractor or may cause tractor damage.

## Product Misuse

Product misuse can cause accidents, injury and death.

The manufacturer of the attachment is not responsible for any harm or injury resulting from product misuse.

Product misuse includes operating or servicing the attachment without following the instructions in this manual, using the attachment in any way for which it was not designed, and modifying the attachment.

## Modifications

Do not modify the attachment in any way.

## Manufacturer Contact

Call Messer Repair and Fabricating, LLC at (833) 352-3477, or visit [www.messerrepair.com](http://www.messerrepair.com).

# Product Identification and Specifications

## Identification Numbers

Record your product information to provide when you contact the dealer or manufacturer.

### Freestall Groomer

Model FSG

Serial Number 11157-

Model FSG3PT

Serial Number 13938-

### Serial Number Location



Purchase Date	
Dealer	
Dealer Phone	
Model	
Serial #	

## Specifications

<b>Model</b>	FSG
<b>Overall Depth</b>	88.9 cm (35 in.)
<b>Overall Width x Height (Lowered)</b>	3.25 x 0.5 m (128 x 21 in.)
<b>Overall Width x Height (Raised)</b>	1.2 x 2.1 m (48 x 84 in.)
<b>Number of Teeth</b>	8
<b>Length of Teeth</b>	10 cm (4 in.)
<b>Weight</b>	204 kg (450 lb.)
<b>Model</b>	FSG3PT
<b>Overall Depth</b>	88.9 cm (35 in.)
<b>Overall Width x Height (Lowered)</b>	3.28 x 0.9 m (129 x 34 in.)
<b>Overall Width x Height (Raised)</b>	1.2 x 2.1 m (48 x 84 in.)
<b>Number of Teeth</b>	8
<b>Length of Teeth</b>	10 cm (4 in.)
<b>Weight</b>	195 kg (430 lb.)

# Safety Decals

## Decal Locations

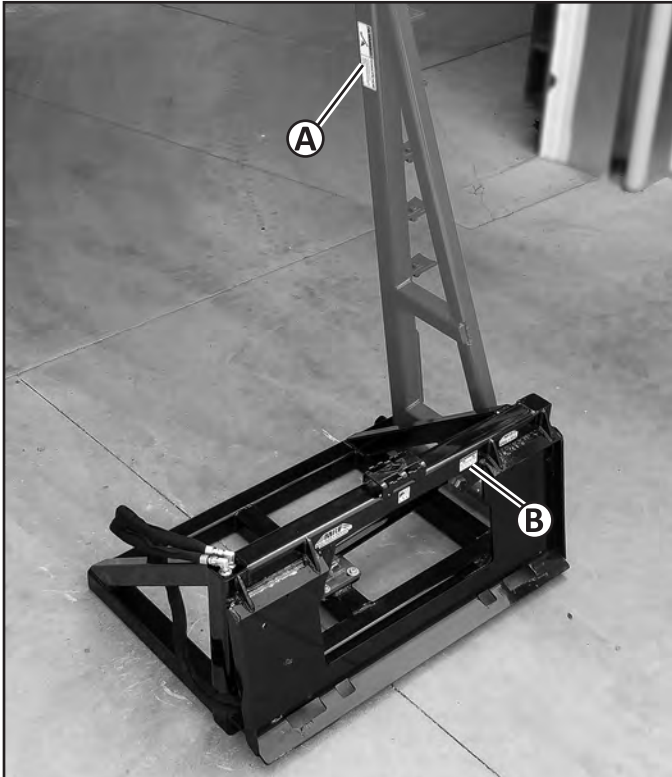

Location	Description	Part Number
A	Warning Decal	96095
B	Warning Decal	96117

## WARNING DECAL 96095

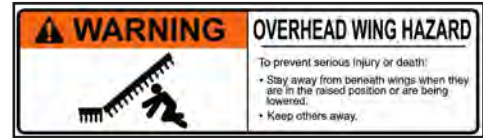

### OVERHEAD WING HAZARD

#### To prevent serious injury or death:

- Stay away from beneath wings when they are in the raised position or are being lowered.
- Keep others away.

## WARNING DECAL 96117



### HIGH PRESSURE FLUID HAZARD

#### To prevent serious injury or death:

- Relieve pressure on system before repairing, adjusting or disconnecting.
- Wear proper hand and eye protection when searching for leaks. Use wood or cardboard instead of hands.
- Keep all components in good repair.

# Safety

## Wear Protective Equipment

- Wear gloves to protect hands from burns if hydraulic couplers become hot during operation.
- Never wear sandals or other light footwear when operating or servicing the attachment. Wear protective footwear when handling blades.
- Do not wear loose fitting clothing which may become entangled when operating or servicing the attachment.

## Parking Safely

*Note: Follow instructions in your tractor operator's manual to park the tractor safely.*

1. Follow the instructions in the loader operator's manual to park the loader safely.
2. Fully lower the attachment to level ground.
3. Stop the loader engine and remove the key from the switch.
4. Do not leave the loader operator seat until the engine and all other moving loader and attachment parts have stopped.
5. Follow the instructions in the loader operator's manual to exit the loader safely. Use the attachment step area if one is provided.

## Operating Safely

*Note: Follow instructions in your tractor operator's manual to operate the tractor safely.*

- Do not allow anyone to operate the attachment unless they have first read and understood the loader and the attachment operator's manuals.
- Do not allow anyone to operate the attachment unless they have first read and understood the safety and warning decals on the loader and on the attachment.
- The attachment owner is responsible for training others to safely operate the attachment, and is responsible for any injuries or harm which occurs while the attachment is being operated.
- If an area to step on the attachment has been provided, be sure to use it when entering and exiting the loader.

- Before operating, replace any worn or damaged safety decals.
- Before operating, thoroughly inspect the attachment to be sure all hardware (bolts, nuts, etc.) is installed and tightened.
- Before operating, thoroughly inspect the attachment to be sure it is in working order. If the attachment is damaged or otherwise not in working order, do not operate until it has been repaired by a qualified technician.
- Before raising or lowering the attachment be sure the area is clear of bystanders.
- Do not operate the loader or the attachment if you are under the influence of alcohol, drugs, or medications which may cause drowsiness.
- Do not allow children to operate the loader or the attachment.
- Do not allow anyone who has not been trained to operate the loader or the attachment.
- Never allow riders on the attachment.
- Keep hands, feet or other objects away from underneath the attachment while operating.
- Fully lower the attachment to level ground when you are done operating.
- Never leave the attachment unattended while in a raised position.
- When transporting the attachment installed on the loader, travel at a slower speed to maintain control.

## Servicing Safely

- Disconnect the attachment hydraulic hoses from the loader or tractor before servicing. Do not service the attachment when the hydraulic hoses are installed on the loader or tractor.
- Remove the attachment from the loader or tractor before servicing when instructed to do so in this manual.
- Do not allow anyone to service the attachment unless they have first read and understood the loader or tractor and the attachment operator's or service manuals.
- Do not allow anyone to service the attachment unless they have first read and understood the safety

# Safety

and warning decals on the loader or tractor and on the attachment.

- The attachment owner is responsible for training others to safely service the attachment, and is responsible for any injuries or harm which occurs while the attachment is being serviced.
- Before inspecting or servicing the attachment, follow the Parking Safely instructions in this manual and disconnect the attachment hydraulic hoses from the loader or tractor.
- Always securely block the attachment to prevent accidental release of the lifting mechanism when inspecting or servicing the attachment.

See the Safety Decal Location illustration in this manual to confirm where decals are installed on the attachment.

Safety decals which are missing, worn or faded must be replaced. Replacement safety decal part numbers are included in this manual. Contact the attachment manufacturer for replacement decals.

## Hydraulic Fluid Safety

- Read and understand the hydraulic safety information in the loader or tractor operator's manual before operating or servicing the attachment.
- Use cardboard or a board when you check for a leak.
- Fluid in hydraulic hoses is under extreme pressure. If fluid is injected into your skin seek medical treatment immediately.
- Do not handle any hydraulic components until pressure has been relieved from the system.
- Disconnect the attachment hydraulic hoses from the loader or tractor before inspection or service.
- Inspect attachment hydraulic hoses and hose shields for damage or wear before attaching to the loader or tractor.

## Safety Decals

Safety decals may be installed on the attachment to warn users of safety hazards:

- **DANGER** decals provide warnings about hazardous situations which will result in death or serious injury if not avoided.
- **WARNING** decals provide warnings about hazardous situations which could result in death or serious injury if not avoided.
- **CAUTION** decals provide warnings about hazardous situations which could result in injury if not avoided.

Read and understand all safety decals before operating or servicing the attachment.



# Installing and Removing

## Preparing for Installation

1. Check the loader or tractor and attachment hydraulic couplers to be sure the surfaces are clean before connecting.
2. Inspect the couplers for damage or wear and replace if needed for proper connection.

## Installing the Attachment (Loader)

1. Follow the instructions in the loader operator's manual to install the attachment and exit the operator station safely.
2. Fully lower the loader lift arms.

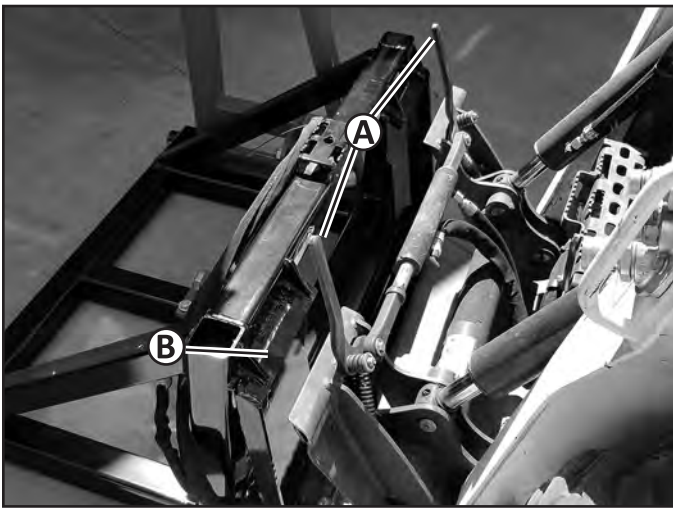

3. Move the loader attaching plate levers (A) to the unlocked (up) position either manually or by using the loader controls.



### IMPORTANT

#### AVOID DAMAGE!

Attaching plate levers may be damaged if they strike the attachment. Be sure the attaching plate levers do not hit the attachment during installation.

4. Tilt the loader attaching plate forward, and drive the loader forward until the top edge of the loader attaching plate is under the top flange (B) of the attachment mounting frame.
5. Raise the loader lift arms slightly until the attaching plate is fully seated under the top flange.
6. Tilt the attaching plate backward to raise the front of the attachment.

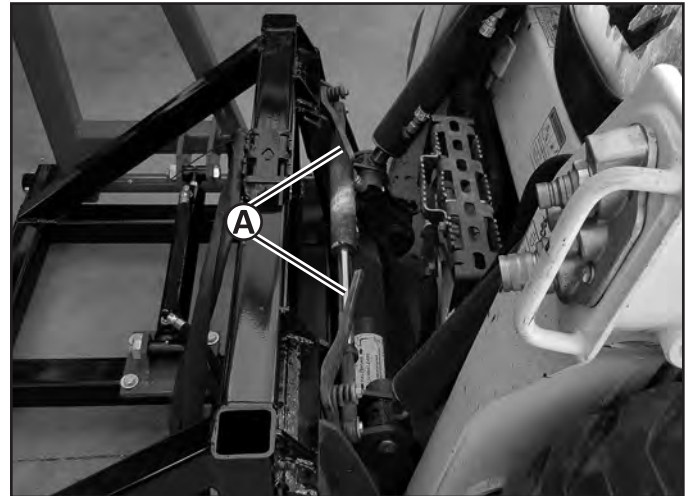

7. Move the loader attaching plate levers (A) to the locked (fully down) position either manually or by using the loader controls.
8. Park the loader. (See Parking Safely in this manual.)



### IMPORTANT

#### AVOID DAMAGE!

The attachment may come off the loader if it is not secured to the attaching plate. The attaching plate pins or wedges must be extended into the attachment with the levers fully down.



*Picture Note: Wedge on left side shown. Check the wedges or pins on both sides of the attachment.*

9. Check to be sure the loader attaching plate pins or wedges (C) extended into the holes in the bottom of the attachment mounting frame. If not, move the loader attaching plate levers to the unlocked (up) position and repeat installation.

## Installing and Removing

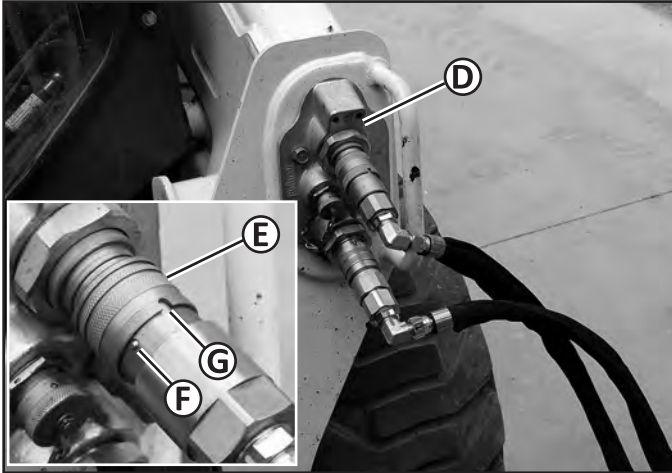

10. Connect the attachment hydraulic hoses to the loader's front auxiliary couplers (D).
  - a. Install the male couplers into the female couplers and pull or push the sleeves (E) to be sure they are locked into place.
  - b. Rotate the coupler sleeves as shown so the ball (F) is outside the groove (G) to prevent the coupler disconnecting (Some sleeves may not have this locking mechanism).

### Removing the Attachment (Loader)

1. Follow the instructions in the loader operator's manual to remove the attachment and exit the operator station safely.
2. Fully lower the loader lift arms and the attachment to level ground.
3. Follow instructions in the loader operator's manual to relieve hydraulic pressure in the front auxiliary hydraulic coupler lines.

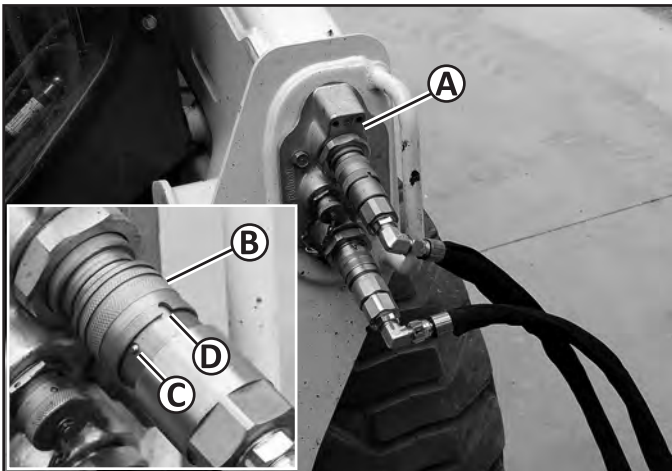

4. Stop the loader engine.

**WARNING**  
**AVOID INJURY!**  
Hydraulic couplers may become hot during operation. Avoid burns by wearing gloves when disconnecting hydraulic couplers.

5. Disconnect the attachment hydraulic hoses from the loader's front auxiliary couplers (A).
  - a. Rotate the coupler sleeves (B) so the ball (C) is aligned with the groove (D) to allow the coupler to disconnect (Some sleeves may not have this locking mechanism).
  - b. Grasp and push or pull the sleeves to disconnect the couplers.

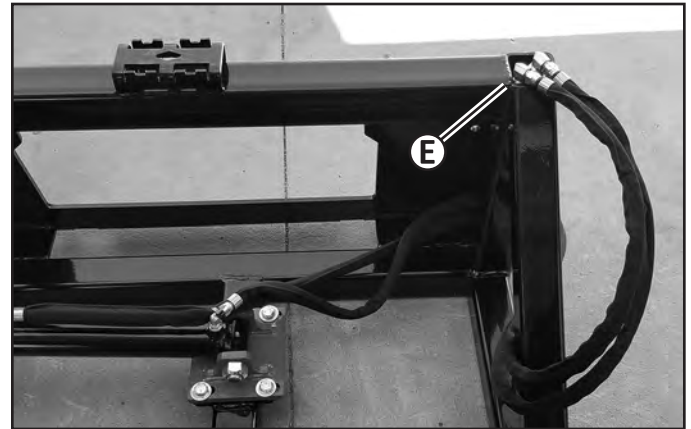

6. Install protective caps on the couplers if they are provided, and insert couplers in the tube (E).

**WARNING**  
**AVOID INJURY!**  
Loader attaching plate levers which are operated manually may have spring tensioning. Firmly grasp the levers and move the levers slowly.



## Installing and Removing

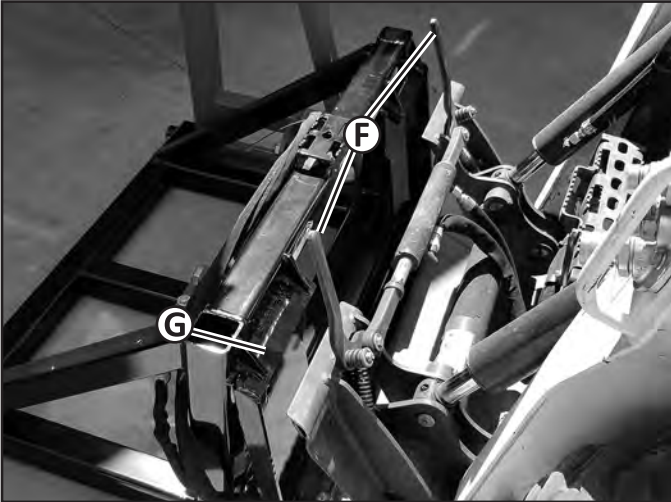

7. Move the loader attaching plate levers (F) to the unlocked (up) position as shown either manually or by using the loader controls.
8. Tilt the loader attaching plate forward slightly and drive the loader backward until the top edge of the attaching plate clears the top flange (G) of the attachment mounting frame.

### Installing and Removing the Attachment (Tractor)

1. Follow the instructions in your tractor and 3 Point Hitch operator's manuals to install and remove the attachment safely.

# Operating

## Pre-Operation Inspection

Before starting operation, inspect the area you will be operating in and inspect the attachment.

### Inspect the Work Area

1. Confirm the area is clear of bystanders including animals. Establish a safety zone by keeping bystanders and animals beyond a 100 foot radius around the attachment when operating.

### Inspect the Attachment

1. Inspect the attachment to be sure it is in working order. If the attachment is damaged or not in working order, do not operate until it has been repaired by a qualified technician.

## Description

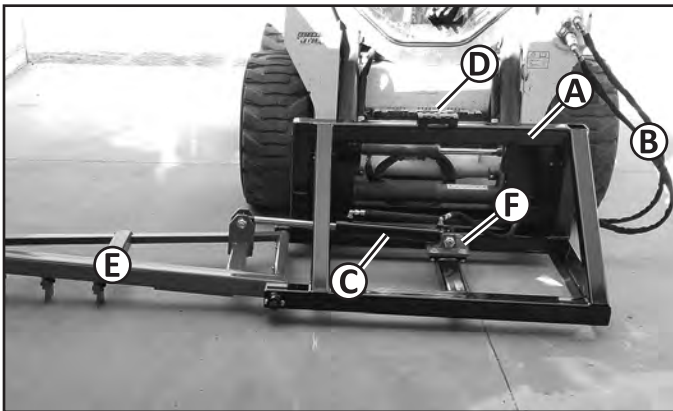

- |                        |               |
|------------------------|---------------|
| A - Main Frame         | D - Step Area |
| B - Hydraulic Hoses    | E - Arm       |
| C - Hydraulic Cylinder | F - Slider    |

## Theory of Operation (Loader)

The Freestall Groomer hydraulic hoses are connected to the loader front auxiliary hydraulic couplers. The loader's hydraulic controls are used to extend and retract the hydraulic cylinder, which lowers and raises the arm. The angle of the arm can be adjusted with the slider to slope bedding in stalls.

## Operation

**Note:** Follow instructions in your tractor operator's manual to park and operate the tractor safely.

1. Follow the instructions in the Installing and Removing section to install the attachment.
2. Park the loader or tractor. (See Parking Safely in this manual.)
3. Perform the pre-operation inspection.
4. Adjust the grooming angle if desired.

### Adjusting the Grooming Angle

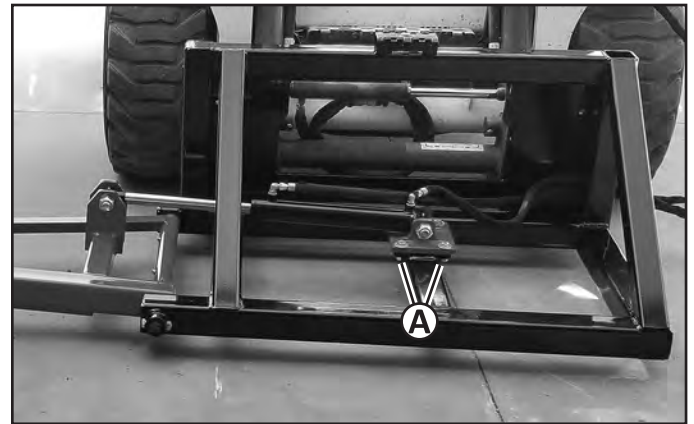

1. Use the loader hydraulic controls to fully lower the arm in the work area.
2. Park the loader or tractor. (See Parking Safely in this manual.)
3. Loosen the four nuts (A) on the slider.
4. Raise the end of the arm to the desired slope angle and put a block under the arm.
5. Tighten the nuts on the slider.

## Transporting the Attachment

### On the Loader

Check to be sure the attachment is correctly installed on the loader before hauling the loader on a trailer or truck. Follow all loader, truck or trailer operator's manual instructions to safely haul the loader.

### On the Tractor

Check to be sure the attachment is correctly installed on the tractor before hauling the tractor on a trailer or truck.

# Operating

Follow all tractor, truck or trailer operator's manual instructions to safely haul the tractor.

## **Hauling the Attachment**

Follow all truck or trailer operator's manual instructions to securely fasten the attachment to the truck or trailer with straps or chains.

# Servicing

## Service Intervals

### Every 8 hours or daily:

- Grease the arm.
- Grease the cylinder.
- Inspect the attachment and hoses for damage and wear. Replace parts as needed.
- Check and tighten all hardware.

### Weekly:

- Inspect teeth for wear. Rotate or replace as needed.

## Lubrication

*Note: Follow instructions in your tractor operator's manual to park the tractor safely.*

### Recommended Grease

Standard Lithium

### Greasing the Arm

1. Park the loader. (See Parking Safely in this manual.)



2. Disconnect the attachment hydraulic hoses from the loader or tractor.

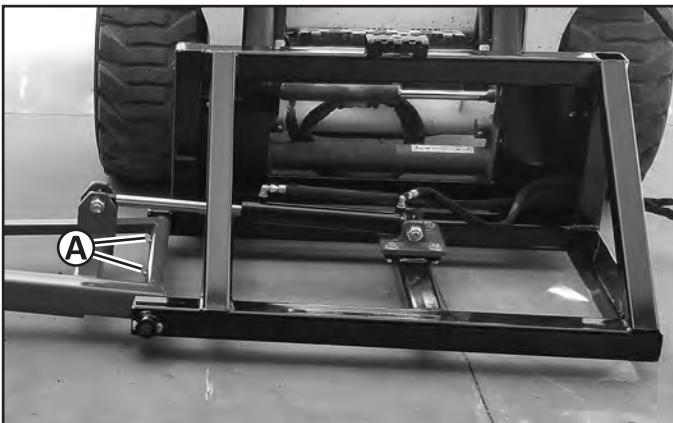

3. Lubricate the two grease fittings (A) on the arm.

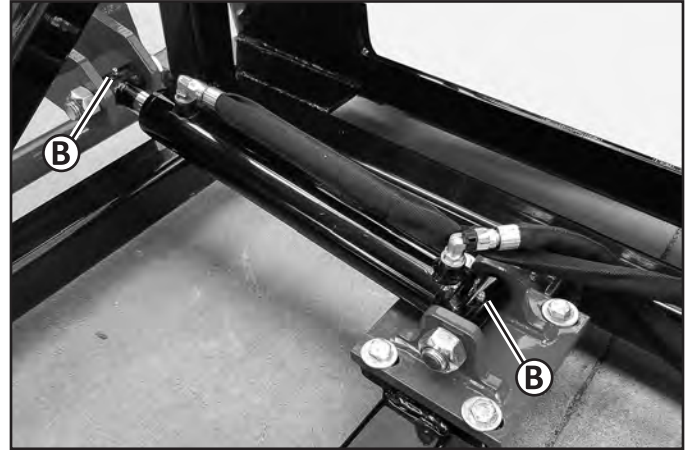

4. Lubricate the two grease fittings (B) on the ends of the cylinder.

## Replacing the Hydraulic Hoses

*Note: Follow instructions in your tractor operator's manual to park the tractor safely.*

1. Fully lower the arm and park the loader. (See Parking Safely in this manual.)



2. Disconnect the attachment hydraulic hoses from the loader.

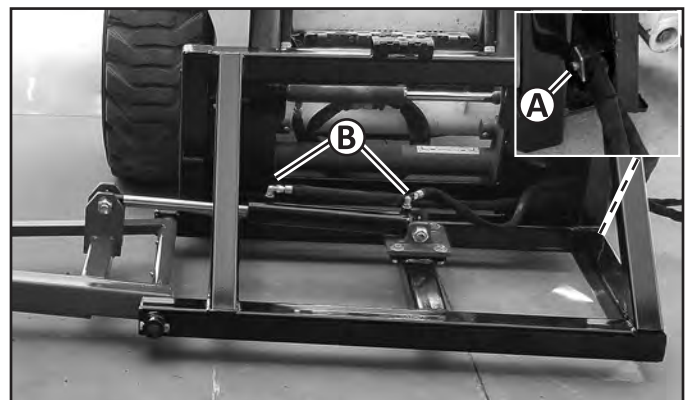

3. Remove the bolt and the hose retainer (A).
4. Disconnect the hydraulic hose from the fitting (B) on the cylinder.
5. Remove the hose.
6. Install the new hose on the fitting.

## Servicing

7. Route the new hose and secure the hoses with the hose retainer.

### Replacing the Hydraulic Cylinder

*Note: Follow instructions in your tractor operator's manual to park the tractor safely.*



#### WARNING

**AVOID INJURY!**

**Remove the attachment from the loader or tractor before servicing.**

1. Fully retract hydraulic cylinder and raise the arm.
2. Remove the attachment from the loader or tractor.
3. Park the loader. (See Parking Safely in this manual.)
4. Tie the arm in the raised position to the main frame.

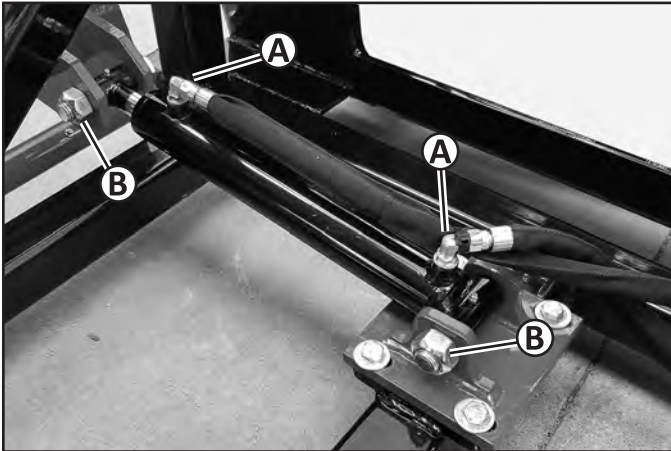

5. Disconnect the fittings (A) and hydraulic hoses from the cylinder.
6. Remove the nuts (B) and bolts and the cylinder.

7. Install the new cylinder with the bolts and nuts.
8. Connect the hydraulic hose fittings to the cylinder.

### Rotating or Replacing Teeth

*Note: Follow instructions in your tractor operator's manual to park the tractor safely.*

1. Fully raise the arm and park the loader. (See Parking Safely in this manual.)



#### WARNING

**AVOID INJURY!**

**Disconnect the attachment hydraulic hoses from the loader or tractor before servicing.**

2. Disconnect attachment hydraulic hoses from loader.

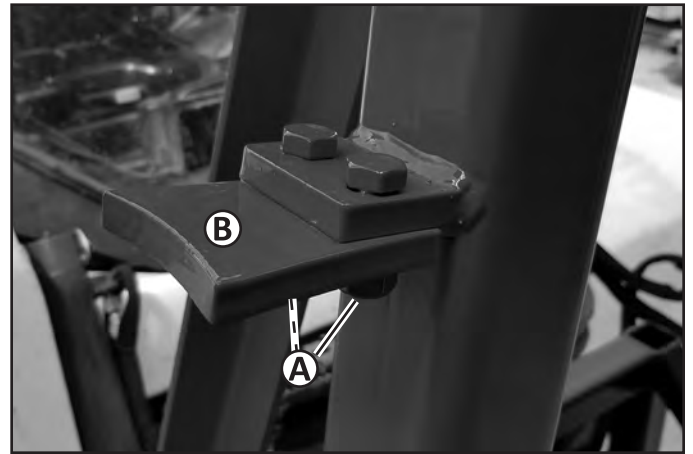

3. Remove nuts (A) and bolts and tooth (B).
4. Rotate or replace tooth and install with bolts and nuts.

### Troubleshooting

Problem	Action
Arm won't raise or lower.	<ol style="list-style-type: none"><li>1. Check to be sure the attachment hydraulic couplers are fully connected.</li><li>2. Check the attachment for hydraulic fluid leaks.</li><li>3. See loader or tractor operator's manual to check hydraulic pressure and flow.</li><li>4. Contact the attachment manufacturer about possible cylinder replacement.</li></ol>
Loader or tractor tires spin.	<ol style="list-style-type: none"><li>1. Raise the arm to work less material and make additional passes if needed.</li><li>2. Clean the work area where the loader or tractor is traveling. Add sand or grit.</li></ol>
Bedding material is too hard to groom.	<ol style="list-style-type: none"><li>1. Lower the arm to work more material and make additional passes.</li><li>2. Contact the manufacturer for longer teeth.</li></ol>



# Replacement Parts

## Replacement Parts

Contact Messer Repair and Fabricating, LLC for replacement parts.

Part numbers may change without notice.

Item	Qty.	Part Number	Part Description
1	1	07619	Main Frame Weldment FSG
1	1	07641	Main Frame Weldment FSG3PT
2	1	WCT2X12	Cylinder, 2 x 12 Welded Crosstube
3	1	06557	Slide Weldment
4	1	91236A924	Bolt, 1 x 5 in.
5	1	92501A462	Locknut, 1 - 8
6	20	91309A716	Bolt, 1/2 x 1.5 in.
7	4	98023A033	Washer, Flat, 1/2
8	22	91837A262	Locknut, Steel, 1/2
9	1	07622	Arm Weldment
10	1	91247A922	Bolt, 1 x 4.5 in.
11	1	03036	Arm Pin
12	2	91247A722	Bolt, 1/2 x 2.5 in.
13	8	06804	Tooth, 4 in.
13	8	10700	Tooth, 7 in.
*		FSG4T-KIT	4 in. Tooth Kit (no hardware)
*		FSG7T-KIT	7 in. Tooth Kit (no hardware)
*	4	60105	Grease Zerk, Straight, 0.25 x 28
*	4	1133076	Washer, 0.5625 ID
*	1	96290	Base End Hose Assembly
*	1	96291	Rod End Hose Assembly
*	2	6801-06-08	Adapter, 90-degree
*	2	6801-06-06	Adapter, 90-degree
*	1	T-2004HS	Twin Hydraulic Hose Clamp
*	1	96164	Flat Face Coupler Assembly, Female
*	1	96165	Flat Face Coupler Assembly, Male

\* Part not shown.

## Replacement Parts

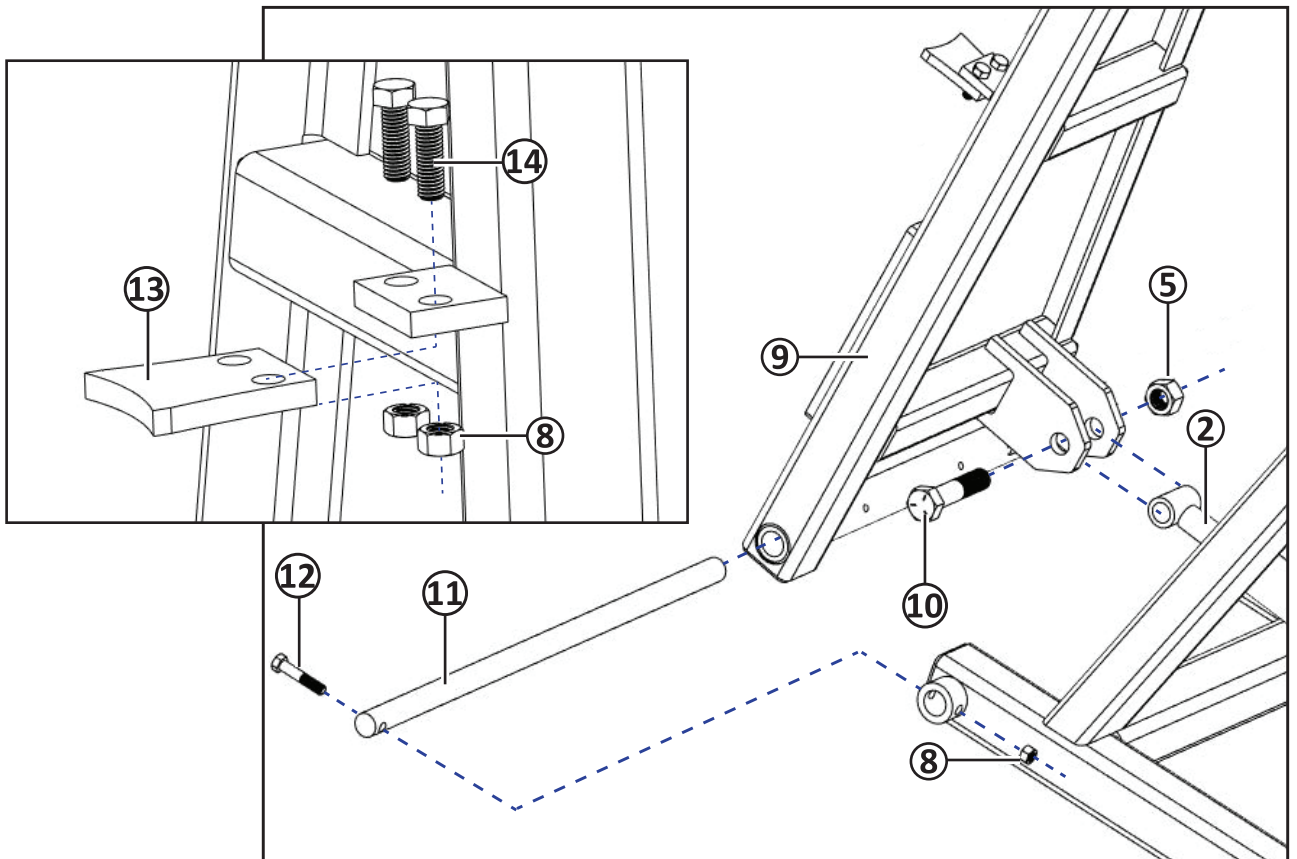
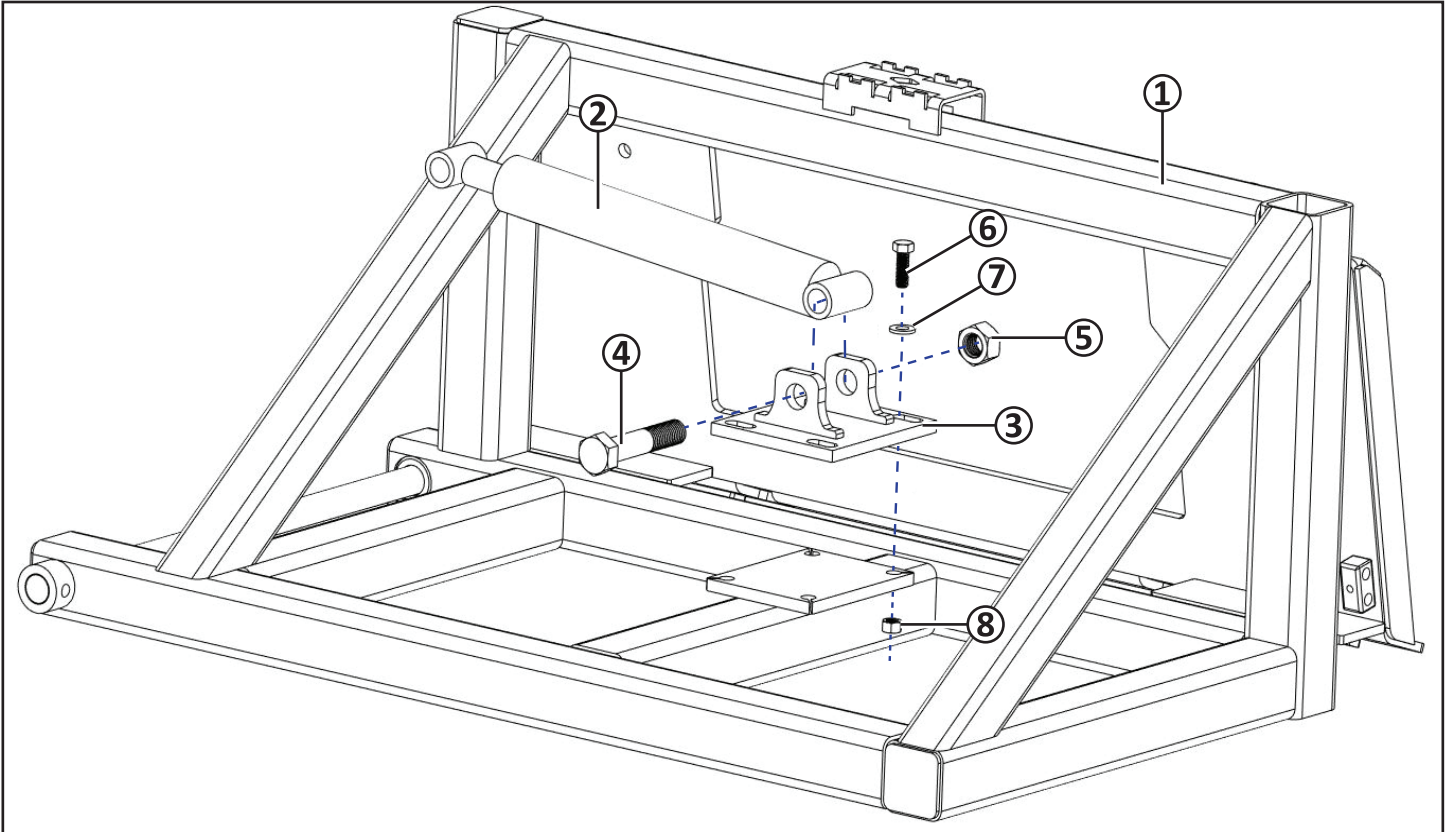

# Warranty

## MESSER REPAIR & FABRICATING, LLC

### Limited Warranty and Terms and Conditions of Sale

The following limited warranty, and terms and conditions of sale (the “Limited Warranty”) apply to all equipment, products, parts, and goods (any of the foregoing are referred to herein as “Equipment”) sold by Messer Repair & Fabricating, LLC (“Messer”):

1. Covers All Equipment. Each purchase of Equipment by a purchaser is expressly made conditional on purchaser’s assent to the terms and conditions in this Limited Warranty.
2. Limited Warranty. Messer warrants that for a period of 24 months from the date of purchase, the Equipment will remain free from defects in material and workmanship under normal use and proper maintenance. Messer’s obligation under the warranty shall be limited to the repair or replacement (at Messer’s option) of the Equipment. Notwithstanding the foregoing, if the Equipment is used for commercial purposes or is rented or leased out by the purchaser, then, the foregoing warranty shall only be for a period of 180 days and not 24 months.
3. No Warranty For Equipment Components From Third Parties. Notwithstanding the limited warranty terms set forth above, MESSER OFFERS NO WARRANTY WHATSOEVER WITH RESPECT TO ANY COMPONENTS OF THE EQUIPMENT MADE OR PROVIDED TO MESSER BY OTHER MANUFACTURERS, PRODUCERS, OR SELLERS (the “Purchased Components”). The sole and exclusive warranty for each the Purchased Components shall be limited to the express written warranty with respect to the Purchased Component as provided by the manufacturer, producer, or seller of such Purchased Component. Messer’s responsibility and liability for the Purchased Components shall be limited to the assignment of the Purchased Components’ express written warranties applicable to the Purchased Components. Purchased Components include, without limitation, the following: axles, tires and rims; trailer hitch components and jacks; hydraulic pumps, motors, cylinders and components; and bales spears, pallet tines, and bucket teeth.
4. No Other Warranties. THE FOREGOING REPAIR AND REPLACEMENT OBLIGATIONS IN SECTION 2 ARE IN LIEU OF ALL OTHER WARRANTIES, LIABILITIES AND OBLIGATIONS, INCLUDING ALL WARRANTIES OF MERCHANTABILITY, OF FITNESS FOR A PARTICULAR PURPOSE OR OTHERWISE, EXPRESSED OR IMPLIED IN FACT OR BY LAW, AND STATE MESSER’S ENTIRE AND EXCLUSIVE LIABILITY AND PURCHASER’S EXCLUSIVE REMEDY FOR ANY CLAIM IN CONNECTION WITH THE SALE AND PURCHASE OF EQUIPMENT (AND ALL COMPONENTS THEREOF), THEIR DESIGN, SUITABILITY FOR USE, INSTALLATION OR OPERATIONS.
5. Location of Warranty Repairs. All warranty repairs pursuant to this Limited Warranty shall be made at Messer’s corporate manufacturing plant, or other location as determined by Messer, at its discretion. Purchaser shall be responsible for and pay for any transportation expenses necessary for Limited Warranty repairs.
6. Limited Warranty Voidable. The limited warranty herein is void and deemed waived if the purchaser fails to give written notice to Messer of any alleged defect under the limited warranty herein within 20 days of its discovery; or (a) purchaser or parties other than Messer or its authorized representatives attempts to remedy or fix the alleged Equipment defects; or (b) purchaser has used the Equipment for purposes it was not intended to be used for; or (c) purchaser has not operated the Equipment in a manner consistent with Messer’s instructions for the Equipment; or (d) the Equipment has been modified, altered, abused, or misused; or (e) the Equipment has been damaged pursuant to accident, fire, flood, or other Act of God.
7. No Consequential Damages. IN NO EVENT SHALL MESSER BE LIABLE FOR ANY DIRECT, INDIRECT, SPECIAL OR CONSEQUENTIAL DAMAGES WHATSOEVER, AND MESSER’S LIABILITY, UNDER NO CIRCUMSTANCES, WILL EXCEED THE PRICE PAID FOR THE EQUIPMENT FOR WHICH LIABILITY IS CLAIMED.
8. Governing Law. This contract shall be governed by the laws of the State of Minnesota.
9. Arbitration. Any controversy or claim arising out of or relating to the limited warranty provided herein, or any alleged breach thereof, shall be settled exclusively by arbitration in accordance with the Rules of the American Arbitration Association, and judgment upon the award rendered by the arbitrator may be entered in any court having jurisdiction thereof. The arbitration shall be conducted in Minneapolis, MN, by one arbitrator selected by Messer and Purchaser, or, if they cannot agree, the President of the American Arbitration Association.